

SNH

MANCAL	SNH 200	SNH 300	SNH 500	SNH 600
EIXO	25 A 160MM	25 A 100MM	20 A 140MM	20 A 90MM
ROLAMENTO	Rolamentos autocompensadores de esferas das séries 12-c e 22-c, e rolamentos autocompensadores de rolos das séries 222-c e 32-c	Rolamentos autocompensadores de esferas das séries 13-c e 23-c, e rolamentos autocompensadores de rolos das séries 213-c e 23-c	Rolamentos autocompensadores de esferas das séries 12-k e 22-k, e rolamentos autocompensadores de rolos das séries 222-k e 32-k	Rolamentos autocompensadores de esferas das séries 13-k e 23-k, e rolamentos autocompensadores de rolos das séries 213-k e 23-k
COM BUCHA DE FIXAÇÃO?	NÃO	NÃO	SIM	SIM
COM 2 FUROS	SNH 200	SNH 300	SNH 500	SNH 600
COM 4 FUROS:	FSNH 200	FSNH 300	FSNH 500	FSNH 600
CARACTERÍSTICA	Bipartidas	Bipartidas	Bipartidas	Bipartidas
APLICAÇÃO	Para aplicações gerais com cargas normais, devendo tomar as precauções ao seleccionar rolamento e vedações para cada condição de aplicação.	Para aplicações gerais com cargas normais, devendo tomar as precauções ao seleccionar rolamento e vedações para cada condição de aplicação.	Para aplicações gerais com cargas normais, devendo tomar as precauções ao seleccionar rolamento e vedações para cada condição de aplicação.	Para aplicações gerais com cargas normais, devendo tomar as precauções ao seleccionar rolamento e vedações para cada condição de aplicação.
LUBRIFICAÇÃO PADRÃO	Graxa	Graxa	Graxa	Graxa
LUBRIFICAÇÃO OPCIONAL	Óleo	Óleo	Óleo	Óleo
VEDAÇÃO PADRÃO	TC (tsnh-c)	TC (tsnh-c)	TC (tsnh-c)	TC (tsnh-c)
VEDAÇÃO OPCIONAL	TG (tsnh-g), TA (tsnh-a), TS (tsnh-s)	TG (tsnh-g), TA (tsnh-a), TS (tsnh-s)	TG (tsnh-g), TA (tsnh-a), TS (tsnh-s)	TG (tsnh-g), TA (tsnh-a), TS (tsnh-s)
TABELA COMPLETA	SNH 200 / FSNH 200	SNH 300 / FSNH 300	SNH 500 / FSNH 500	SNH 600 / FSNH 600

SNH 200 / FSNH 200

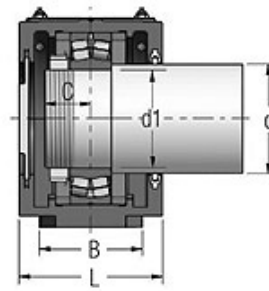
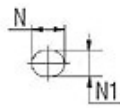
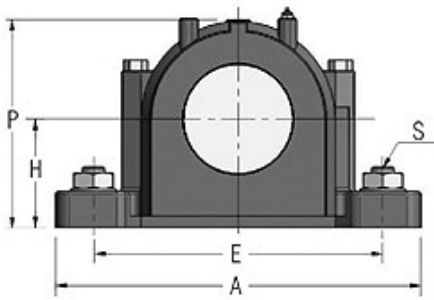

Execução Cega

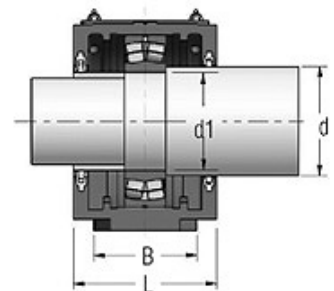

Execução Passante

Caixa	d1	d	Rolam.	Arruela	Porca	Dimensões (mm)											Anel Dim.	FRB Qtd.	Peso (kg)
						H	E	A	B	C	L	N	N1	P	S	V			
SNA-H 205	25	30	1205C 2205C 22205C	MB 5	KM 5	40	130	165	46	18	67	20	15	74	12	19	5/52 3,5/52 3,5/52	2 2 2	1,40
SNA-H 206	30	35	1206C 2206C 22206C	MB 6	KM 6	50	150	185	52	19	77	20	15	89	12	22	8/62 6/62 6/62	2 2 2	1,90
SNA-H 207	35	45	1207C 2207C 22207C	MB 7	KM 7	50	150	185	52	21	82	20	15	93	12	22	8,5/72 5,5/72 5,5/72	2 2 2	2,10
SNA-H 208	40	50	1208C 2208C 22208C	MB 8	KM 8	60	170	205	60	22	85	20	15	107	12	25	10,5/80 8/80 8/80	2 2 2	2,75
SNA-H 209	45	55	1209C 2209C 22209C	MB 9	KM 9	60	170	205	60	23	85	20	15	109	12	25	5,5/85 3,5/85 3,5/85	2 2 2	3
SNA-H 210	50	60	1210C 2210C 22210C	MB 10	KM 10	60	170	205	60	24	90	20	15	113	12	25	10,5/90 9/90 9/90	2 2 2	3
SNA-H 211	55	65	1211C 2211C 22211C	MB 11	KM 11	70	210	255	70	26	95	24	18	127	16	28	11,5/100 9,5/100 9,5/100	2 2 2	4,20
SNA-H 212	60	70	1212C 2212C 22212C	MB 12	KM 12	70	210	255	70	28	105	24	18	133	16	30	13/110 10/110 10/110	2 2 2	4,75
SNA-H 213	65	75	1213C 2213C 22213C	MB 13	KM 13	80	230	275	80	31	110	24	18	148	16	30	14/120 10/120 10/120	2 2 2	6,10
SNA-H 215	75	85	1215C 2215C 22215C	MB 15	KM 15	80	230	280	80	32	115	24	18	154	16	30	15,5/130 12,5/130 12,5/130	2 2 2	6,60
SNA-H 216	80	90	1216C 2216C 22216C	MB 16	KM 16	95	260	315	90	35	120	28	22	175	20	32	16/140 12,5/140 12,5/140	2 2 2	9
SNA-H 217	85	95	1217C 2217C 22217C	MB 17	KM 17	95	260	320	90	37	125	28	22	183	20	32	16,5/150 12,5/150 12,5/150	2 2 2	9,50
SNA-H 218	90	100	1218C 2218C 22218C 23218C	MB 18	KM 18	100	290	345	100	46	140	28	22	193	20	35	17,5/160 12,5/160 12,5/160 6,25/160	2 2 2 2	11,80
SNA-H 219	95	110	1219C 2219C 22219C	MB 19	KM 19	112	290	345	100	42	145	28	22	210	20	35	18/170 12,5/170 12,5/170	2 2 2	13,70
SNA-H 220	100	115	1220C 2220C 23220C	MB 20	KM 20	112	320	380	110	50	160	32	26	215	24	40	18/180 12/180 12/180	2 2 2	17,60
SNA-H 222	110	125	1222C 2222C 23222C	MB 22	KM 22	125	350	410	120	58	175	32	26	239	24	45	4,85/180 21/200 13,5/200	2 2 2	22
SNA-H 224	120	135	1224C 23224C	MB 24	KM 24	140	350	410	120	62	185	32	26	271	24	45	5,1/200 22/215 14/215	2 2 2	26
SNA-H 226	130	145	1226C 23226C	MB 26	KM 26	150	380	445	130	65	190	35	28	290	24	50	5/215 13/230 5/230	2 2 2	33
SNA-H 228	140	155	1228C 23228C	MB 28	KM 28	150	420	500	150	70	205	42	35	302	30	50	15/250 5/250	2 2	40
SNA-H 230	150	165	1230C 23230C	MB 30	KM 30	160	450	530	160	76	220	42	35	323	30	60	16,5/270 5/270	2 2	49
SNA-H 232	160	175	1232C 23232C	MB 32	KM 32	170	470	550	160	82	235	42	35	344	30	60	17/290 5/290	2 2	55

SNH 300 / FSNH 300

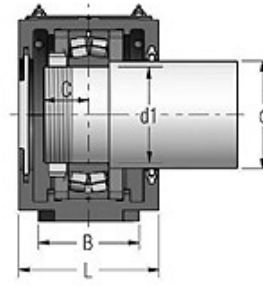
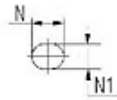
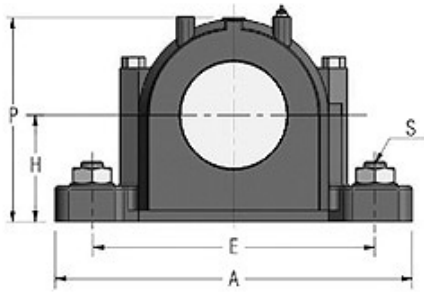

Execução Cega

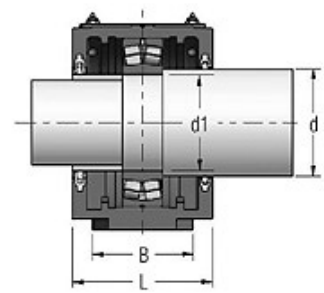

Execução Passante

Caixa	d1	d	Rolam.	Arruela	Porca	Dimensões (mm)											Anel Dim	FRB Qtd.	Peso (kg)
						H	E	A	B	C	L	N	N1	P	S	V			
SNA-H 305	25	30	1305 C 2305 C	MB 5	KM 5	50	150	185	52	22	77	20	15	89	12	22	7,5/62 4/62	2 2	1,90
SNA-H 306	30	35	1306 C 2306 C	MB 6	KM 6	50	150	185	52	22	82	20	15	93	12	22	7,5/72 3,5/72	2 2	2,20
SNA-H 307	35	45	1307 C 2307 C	MB 7	KM 7	60	170	205	60	25	85	20	15	107	12	25	9/80 4/80	2 2	2,90
SNA-H 308	40	50	1308 C 2308 C 21308 C 22308 C	MB 8	KM 8	60	170	205	60	27	90	20	15	113	12	25	9/90 4/90 9/90 4/90	2 2 2 2	3,20
SNA-H 309	45	55	1309 C 2309 C 21309 C 22309 C	MB 9	KM 9	70	210	255	70	30	95	24	18	127	16	28	9,5/100 4/100 9,5/100 4/100	2 2 2 2	4,40
SNA-H 310	50	60	1310 C 2310 C 21310 C 22310 C	MB 10	KM 10	70	210	255	70	33	105	24	18	133	16	30	10,5/110 4/110 10,5/110 4/110	2 2 2 2	5,10
SNA-H 311	55	65	1311 C 2311 C 21311 C 22311 C	MB 11	KM 11	80	230	275	80	35	110	24	18	148	16	30	11/120 4/120 11/120 4/120	2 2 2 2	6,50
SNA-H 312	60	70	1312 C 2312 C 21312 C 22312 C	MB 12	KM 12	80	230	280	80	37	115	24	18	154	16	30	12,5/130 5/130 12,5/130 5/130	2 2 2 2	7
SNA-H 313	65	75	1313 C 2313 C 21313 C 22313 C	MB 13	KM 13	95	260	315	90	39	120	28	22	175	20	32	12,5/140 5/140 12,5/140 5/140	2 2 2 2	9,50
SNA-H 314	70	80	1314 C 2314 C 21314 C 22314 C	MB 14	KM 14	95	260	320	90	41	125	28	22	183	20	32	13/150 5/150 13/150 5/150	2 2 2 2	10
SNA-H 315	75	85	1315 C 2315 C 21315 C 22315 C	MB 15	KM 15	100	290	345	100	43	140	28	22	193	20	35	14/160 5/160 14/160 5/160	2 2 2 2	12,50
SNA-H 316	80	90	1316 C 2316 C 21316 C 22316 C	MB 16	KM 16	112	290	345	100	47	145	28	22	210	20	35	14,5/170 5/170 14,5/170 5/170	2 2 2 2	13,70
SNA-H 317	85	95	1317 C 2317 C 21317 C 22317 C	MB 17	KM 17	112	320	380	110	49	160	32	26	215	24	40	14,5/180 5/180 14,5/180 5/180	2 2 2 2	17,60
SNA-H 319	95	110	1319 C 2319 C 21319 C 22319 C	MB 19	KM 19	125	350	410	120	54	175	32	26	239	24	45	17,5/200 6,5/200 17,5/200 6,5/200	2 2 2 2	22
SNA-H 320	100	115	1320 C 2320 C 21320 C 22320 C	MB 20	KM 20	140	350	410	120	58	185	32	26	271	24	45	19,5/215 6,5/215 19,5/215 6,5/215	2 2 2 2	26

SNH 500 / FSNH 500

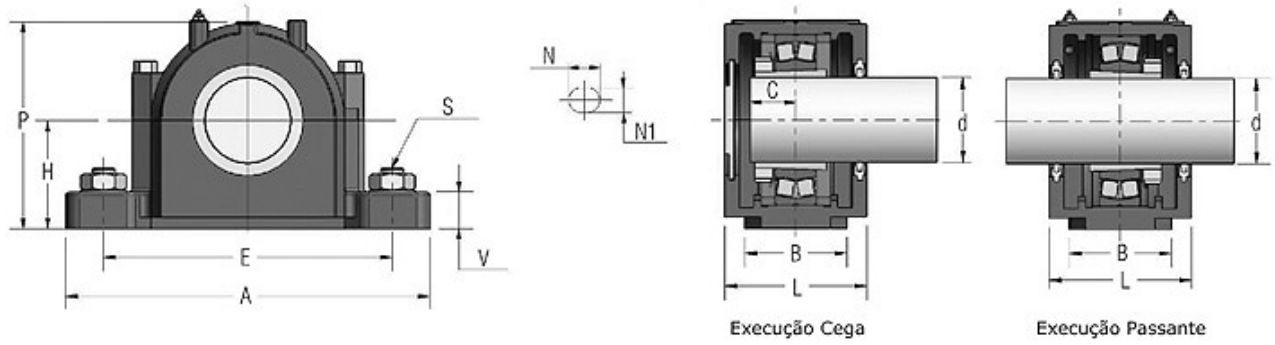

Caixa	d	Rolam.	Buchas	Dimensões (mm)											Anel Dim.	FRB Qtd	Peso (kg)
				H	E	A	B	C	L	N	N1	P	S	V			
SNA-H 505	20	1205K	H 205	40	130	165	46	18	67	20	15	74	12	19	5/52	2	1,5
		2205K	H 305												3,5/52		
		22205K	H 305												3,5/52		
SNA-H 506	25	1206K	H 206	50	150	185	52	19	77	20	15	89	12	22	8/62	2	2
		2206K	H 306												6/62		
		22206K	H 306												6/62		
SNA-H 507	30	1207K	H 207	50	150	185	52	21	82	20	15	93	12	22	8,5/72	2	2,2
		2207K	H 307												5,5/72		
		22207K	H 307												5,5/72		
SNA-H 508	35	1208K	H 208	60	170	205	60	22	85	20	15	107	12	25	10,5/80	2	2,9
		2208K	H 308												8/80		
		22208K	H 308												8/80		
SNA-H 509	40	1209K	H 209	60	170	205	60	23	85	20	15	109	12	25	5,5/85	2	2,9
		2209K	H 309												3,5/85		
		22209K	H 309												3,5/85		
SNA-H 510	45	1210K	H 210	60	170	205	60	24	90	20	15	113	12	25	10,5/90	2	3,2
		2210K	H 310												9/90		
		22210K	H 310												9/90		
SNA-H 511	50	1211K	H 211	70	210	255	70	26	95	24	18	127	16	28	11,5/100	2	4,4
		2211K	H 311												9,5/100		
		22211K	H 311												9,5/100		
SNA-H 512	55	1212K	H 212	70	210	255	70	28	105	24	18	133	16	30	13/110	2	5,1
		2212K	H 312												10/110		
		22212K	H 312												10/110		
SNA-H 513	60	1213K	H 213	80	230	275	80	31	110	24	18	148	16	30	14/120	2	6,5
		2213K	H 313												10/120		
		22213K	H 313												10/120		
SNA-H 515	65	1215K	H 215	80	230	280	80	32	115	24	18	154	16	30	15,5/130	2	7
		2215K	H 315												12,5/130		
		22215K	H 315												12,5/130		
SNA-H 516	70	1216K	H 216	95	260	315	90	35	120	28	22	175	20	32	16/140	2	9,5
		2216K	H 316												12,5/140		
		22216K	H 316												12,5/140		
SNA-H 517	75	1217K	H 217	95	260	320	90	37	125	28	22	183	20	32	16,5/150	2	10
		2217K	H 317												12,5/150		
		22217K	H 317												12,5/150		
SNA-H 518	80	1218K	H 218	100	290	345	100	46	140	28	22	193	20	35	17,5/160	2	12,5
		2218K	H 318												12,5/160		
		22218K	H 318												12,5/160		
SNA-H 519	85	1219K	H 219	112	290	345	100	42	145	28	22	210	20	35	6,25/160	2	13,7
		2219K	H 319												18/170		
		22219K	H 319												12,5/170		
SNA-H 520	90	1220K	H 220	112	320	380	110	50	160	32	26	215	24	40	12/180	2	17,6
		2220K	H 320												18/180		
		22220K	H 320												12/180		
SNA-H 522	100	1222K	H 222	125	350	410	120	58	175	32	26	239	24	45	4,85/180	2	22
		2222K	H 322												21/200		
		22222K	H 322												13,5/200		
SNA-H 524	110	1224K	H 224	140	350	410	120	62	185	32	26	271	24	45	13,5/200	2	26
		2224K	H 324												5/215		
		22224K	H 324												14/215		
SNA-H 526	115	1226K	H 226	150	380	445	130	65	190	35	28	290	24	50	13/230	2	33
		2226K	H 326												5/230		
		22226K	H 326												15/250		
SNA-H 528	125	1228K	H 228	150	420	500	150	70	205	42	35	302	30	50	5/250	2	40
		2228K	H 328												16,5/270		
		22228K	H 328												5/270		
SNA-H 530	135	1230K	H 230	160	450	530	160	76	220	42	35	323	30	60	17/290	2	49
		2230K	H 330												5/270		
		22230K	H 330												17/290		
SNA-H 532	140	1232K	H 232	170	470	550	160	82	235	42	35	344	30	60	5/290	2	55
		2232K	H 332												5/290		

SNH 600 / FSNH 600

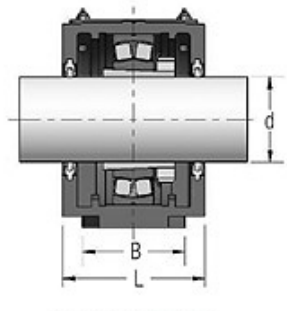
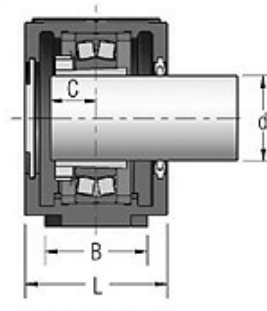
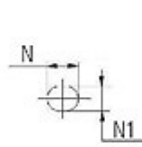
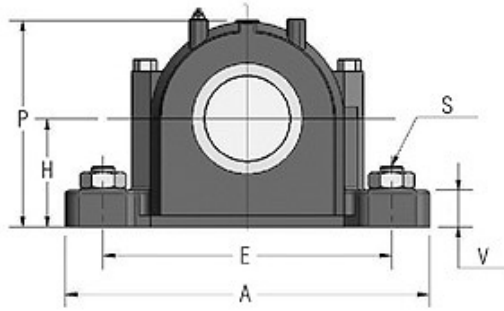

Execução Cega

Execução Passante

Caixa	d	Rolam.	Buchas	Dimensões (mm)											Anel Dim.	FRB Qtd	Peso (kg)
				H	E	A	B	C	L	N	N1	P	S	V			
SNA-H 605	20	1305K	H 305	50	150	185	52	22	77	20	15	89	12	22	7,5/62	2	2
		2305K	H 2305												4/62	2	
SNA-H 606	25	1306K	H 306	50	150	185	52	22	82	20	15	93	12	22	7,5/72	2	2,2
		2306K	H 2306												3,5/72	2	
SNA-H 607	30	1307K	H 307	60	170	205	60	25	85	20	15	107	12	25	9/80	2	2,9
		2307K	H 2307												4/80	2	
SNA-H 608	35	1308K	H 308	60	170	205	60	27	90	20	15	113	12	25	9/90	2	3,2
		2308K	H 2308												4/90	2	
		21308K	H 308												9/90	2	
		22308K	H 2308												4/90	2	
SNA-H 609	40	1309K	H 309	70	210	255	70	30	95	24	18	127	16	28	9,5/100	2	4,4
		2309K	H 2309												4/100	2	
		21309K	H 309												9,5/100	2	
		22309K	H 2309												4/100	2	
SNA-H 610	45	1310K	H 310	70	210	255	70	33	105	24	18	133	16	30	10,5/110	2	5,1
		2310K	H 2310												4/110	2	
		21310K	H 310												10,5/110	2	
		22310K	H 2310												4/110	2	
SNA-H 611	50	1311K	H 311	80	230	275	80	35	110	24	18	148	16	30	11/120	2	6,5
		2311K	H 2311												4/120	2	
		21311K	H 311												11/120	2	
		22311K	H 2311												4/120	2	
SNA-H 612	55	1312K	H 312	80	230	280	80	37	115	24	18	154	16	30	12,5/130	2	7
		2312K	H 2312												5/130	2	
		21312K	H 312												12,5/130	2	
		22312K	H 2312												5/130	2	
SNA-H 613	60	1313K	H 313	95	260	315	90	39	120	28	22	175	20	32	12,5/140	2	9,5
		2313K	H 2313												5/140	2	
		21313K	H 313												12,5/140	2	
		22313K	H 2313												5/140	2	
SNA-H 615	65	1315K	H 315	100	290	345	100	43	140	28	22	193	20	35	14/160	2	12,5
		2315K	H 2315												5/160	2	
		21315K	H 315												14/160	2	
		22315K	H 2315												5/160	2	
SNA-H 616	70	1316K	H 316	112	290	345	100	47	145	28	22	210	20	35	14,5/170	2	13,7
		2316K	H 2316												5/170	2	
		21316K	H 316												14,5/170	2	
		22316K	H 2316												5/170	2	
SNA-H 617	75	1317K	H 317	112	320	380	110	49	160	32	26	215	24	40	14,5/180	2	17,6
		2317K	H 2317												5/180	2	
		21317K	H 317												14,5/180	2	
		22317K	H 2317												5/180	2	
SNA-H 619	85	1319K	H 319	125	350	410	120	54	175	32	26	239	24	45	17,5/200	2	22
		2319K	H 2319												6,5/200	2	
		21319K	H 319												17,5/200	2	
		22319K	H 2319												6,5/200	2	
SNA-H 620	90	1320K	H 320	140	350	410	120	58	185	32	26	271	24	45	19,5/215	2	26
		2320K	H 2320												6,5/215	2	
		21320K	H 320												19,5/215	2	
		22320K	H 2320												6,5/215	2	

CAPACIDADE DE CARGA SNH

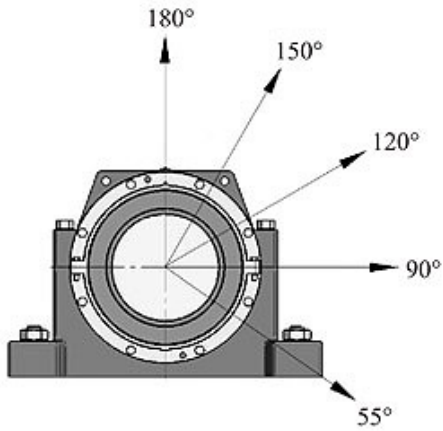

Tamanho da Caixa	Carga de ruptura kN					Limite de escoamento parafusos		
	55°	90°	120°	150°	180°	120°	150°	180°
8	150	90	67	60	75	160	88	80
9	160	96	72	64	80	160	88	80
10	190	114	85	76	95	160	88	80
11	220	132	99	88	110	240	132	120
12	240	144	108	96	120	240	132	120
13	260	156	117	104	130	240	132	120
15	280	168	126	112	140	240	132	120
16	320	192	144	128	160	440	240	220
17	360	216	162	144	180	440	242	220
18	380	228	171	152	190	440	242	220
19	420	254	189	168	210	440	242	220
20	480	288	216	192	240	600	330	300
22	620	372	279	248	310	600	330	300
24	760	456	342	304	380	600	330	300
26	920	552	414	368	460	1100	605	550
28	1100	660	495	440	550	1100	605	550
30	1300	780	585	520	650	1100	605	550
32	1600	960	720	640	800	1100	605	550
34	1700	1020	765	680	850	1500	825	750
36	1995	1197	898	798	998	1500	825	750
38	2430	1458	1093	972	1215	2000	1100	1000
40	2600	1560	1170	1040	1300	2000	1100	1000
44	3200	1920	1440	1280	1600	2000	1100	1000
48	4680	2808	2106	1872	2340	2000	1100	1000
52	5009	3005	2254	2004	2505	2000	1100	1000
56	5356	3214	2410	2142	2678	3200	1760	1600
60	6050	3630	2722	2420	3025	3200	1760	1600
64	7630	4578	3488	3052	3815	3200	1760	1600
68	8121	4872	3654	3248	4060	3200	1760	1600
72	8674	5204	3903	3469	4337	3200	1760	1600
76	9319	5591	4193	3727	4659	3200	1760	1600
80	9810	5886	4411	3924	4905	3200	1760	1600
84	11919	7151	5364	4768	5960	4400	2520	2200
88	12923	7754	5815	5169	6462	4400	2520	2200
92	14311	8587	6440	5724	7156	4400	2520	2200
96	15365	9219	6914	6146	7683	4400	2520	2200
500	18134	10880	8160	7254	9067	4400	2520	2200